

800-966-1265

INSTALLATION INSTRUCTIONS FOR

The Original Trapper™

The Original Trapper™ is not a pressurized vessel - All units should be grounded.

*Skinner Cross Twin stuffing boxes use The Trapper Topper.

STEP 1

Clean areas A, B & C before installing gasket material for proper sealing. (Use wire brush and or substance to remove all oil, grease and dirt). Make sure area is dry and free from all oil (As shown in Figure 1).

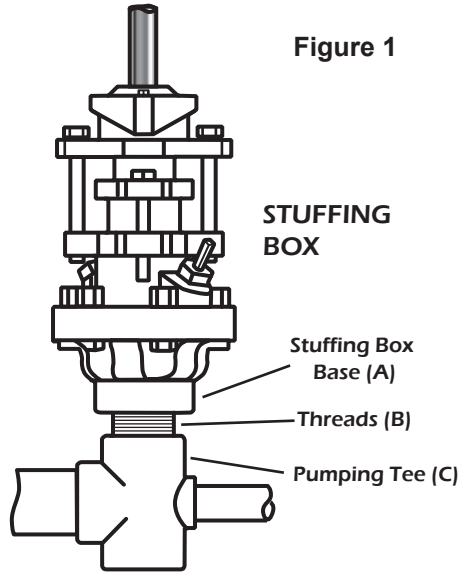

Figure 1

STUFFING BOX

Stuffing Box Base (A)

Threads (B)

Pumping Tee (C)

STEP 2

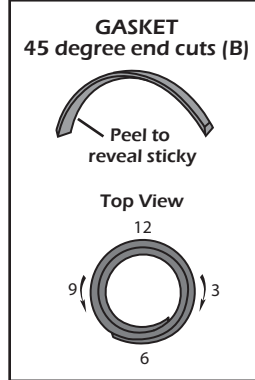

GASKET
45 degree end cuts (B)

Peel to reveal sticky

Top View

12

9

6

3

Figure 2

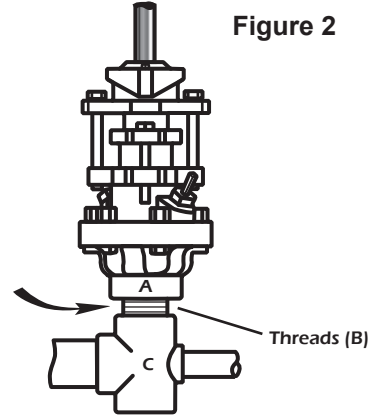

Threads (B)

Figure 2A

1/16" Parting Line Gasket

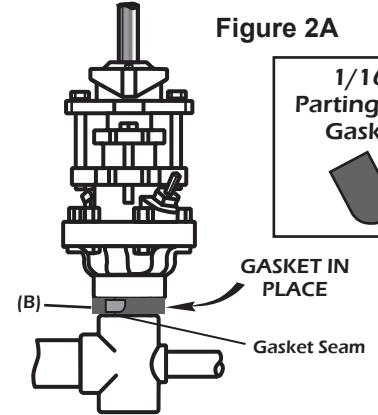

GASKET IN PLACE

Gasket Seam

Wrap the threads (B) with 5/8" foam gasket so that sticky side is against the threads. Begin at 5 o'clock position and wrap firmly until outside of wrap comes flush with stuffing box base (A). Do not stretch material when wrapping as it may tear. Cut gasket end at 45 degree angle. Do not cut gasket at 9 or 3 o'clock position or seam will interfere with Trapper tub seam halves. Use 1 of the enclosed parting line gaskets (as shown in Figure 2A) and stick overlapping the seam as shown.

STEP 3

Install stabilizer bar on top of pumping tee. Brackets should extend above stabilizer bar. Make sure stabilizer bar is level and tighten securely.

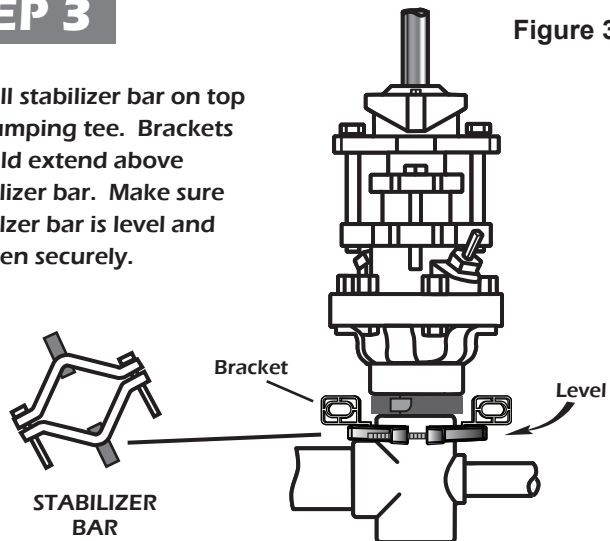
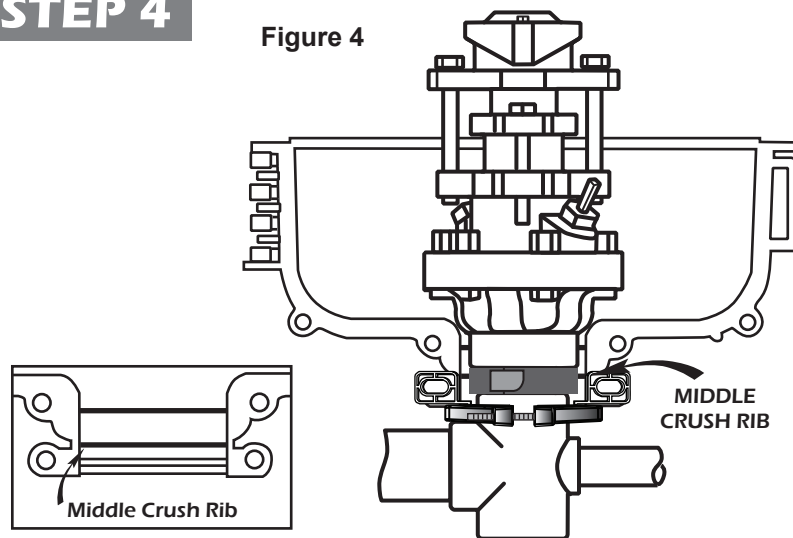

Figure 3

STEP 4

Figure 4



MIDDLE CRUSH RIB

Middle Crush Rib

Separate back half of Trapper Tub and place base flush onto stabilizer bar and pull forward so bottom holes meet stabilizer brackets (as shown). The top 2 crush ribs are the seal points of the Trapper. Note the height of crush ribs so that outer gasket wrap is placed correctly in the next step. The middle crush rib height should be in area B. The stabilizer bar height may need to be adjusted.

STEP 5

Figure 5

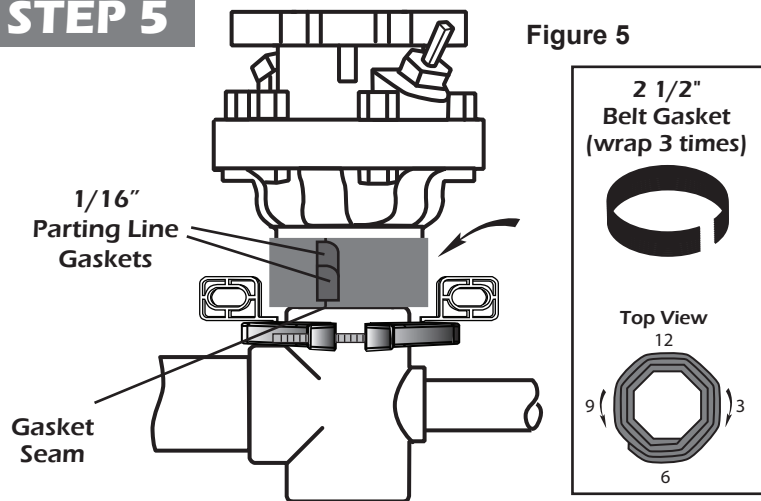

Take foam belt gasket with sticky side down and start in 5 o'clock position and carefully wrap area A & B 3 times as shown. Belt gasket is longer than needed and should be cut at 7 o'clock position at a 45 degree angle to match factory cut. Do not cut at 9 or 3 o'clock position, as seam would interfere with Trapper Tub seam halves. There should be compression around gasket when closing Trapper to seal properly. Use 2 of the enclosed parting line gaskets (as shown in Step 6) and stick overlapping the seam as shown. (If using a single pack octagon based stuffing box, start wrap at 4 o'clock and end at 8 o'clock with 3 full wraps and some overlap. Begin wrap on the hard line edge so there is maximum compression to seal.)

STEP 6

Figure 6

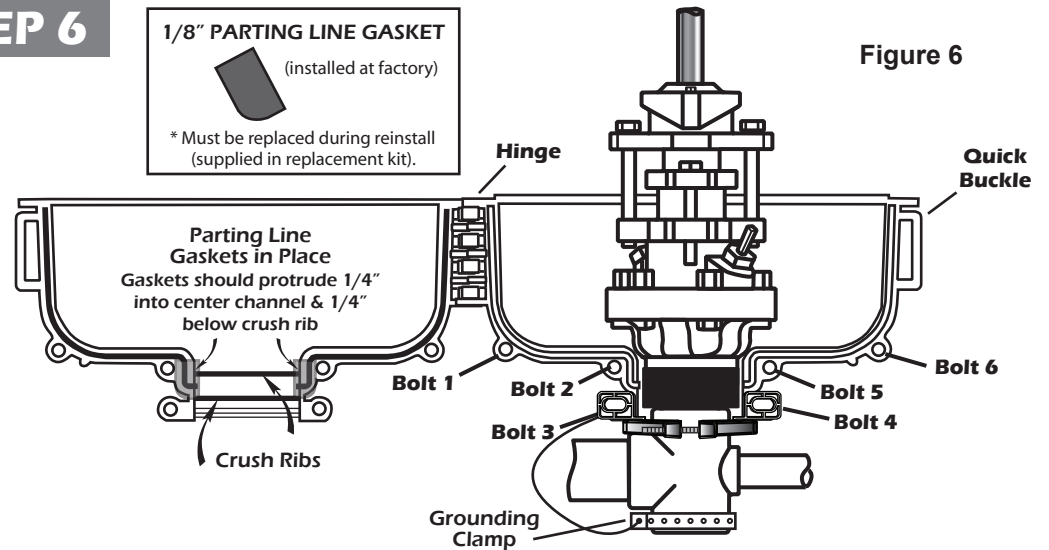

Place back half of Trapper on stabilizer bar and pull forward so Bolt Holes 3 and 4 are pulled flush to stabilizer bar brackets as shown. Slowly close Trapper around stuffing box making sure front half sits on stabilizer bar. Fasten quick buckle on Trapper. Pinch 2 sides together at bolt holes 2 & 5. Insert 3/8" bolts and washers in slots 1 & 6. Tighten bolts to ensure tongue and groove gaskets seal firmly along seam of Trapper halves. Once seam is snug, continue with remaining bolts. Make sure bolts 3 & 4 go through stabilizer brackets. Attach one end of ground wire to bolt 3 or 4 and other to grounding clamp as shown. (Make sure the Trapper is level so lid hole is located squarely in the middle of the unit for polish rod). Two extra 1/4" bolts have been provided for 3 1/2" flow tees to fit Bolts 3 & 4.

STEP 7

Figure 7

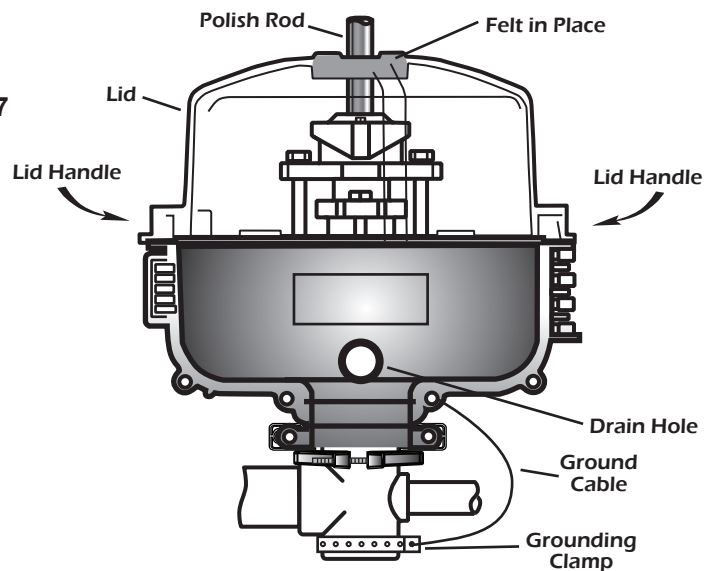

To install Clear Trapper Lid: place center hole of both halves with felt material in place over polish rod at a 45 degree angle to join top tabs together. Bring connected lid down over base holes and turn clockwise. Lid can attach in 6 different positions. Be careful not to torque too hard as to make Trapper Base rotate as this may affect sealing. If Base starts to rotate, gently tighten stabilizer bar. To remove lid turn counter clockwise and lift up. If Trapper has been installed squarely the lid should fit well with polish rod in the center.



800-966-1265

STEP 8A

STEP 8B

WE OFFER THE CHOICE OF TWO CONFIGURATIONS

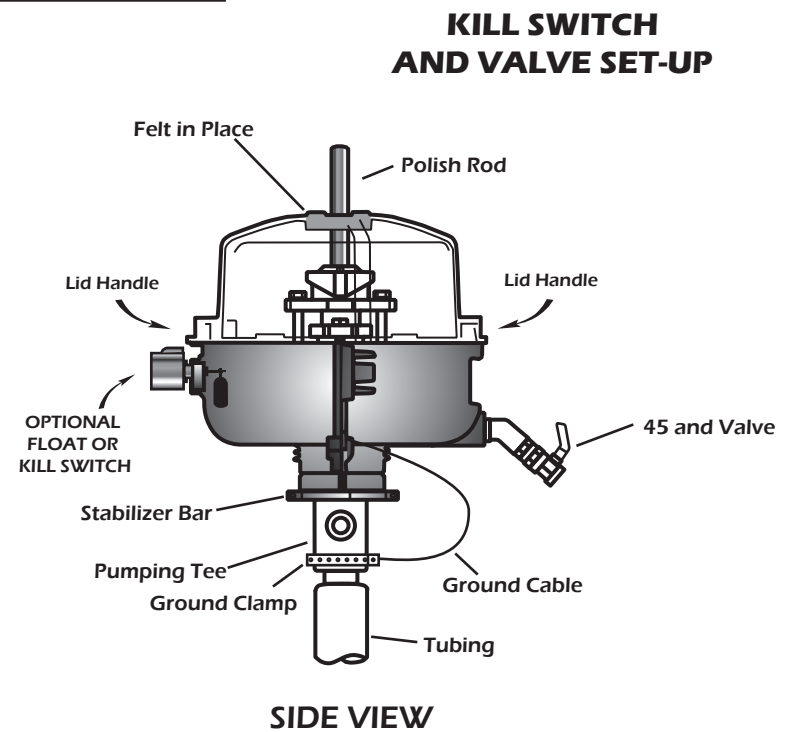
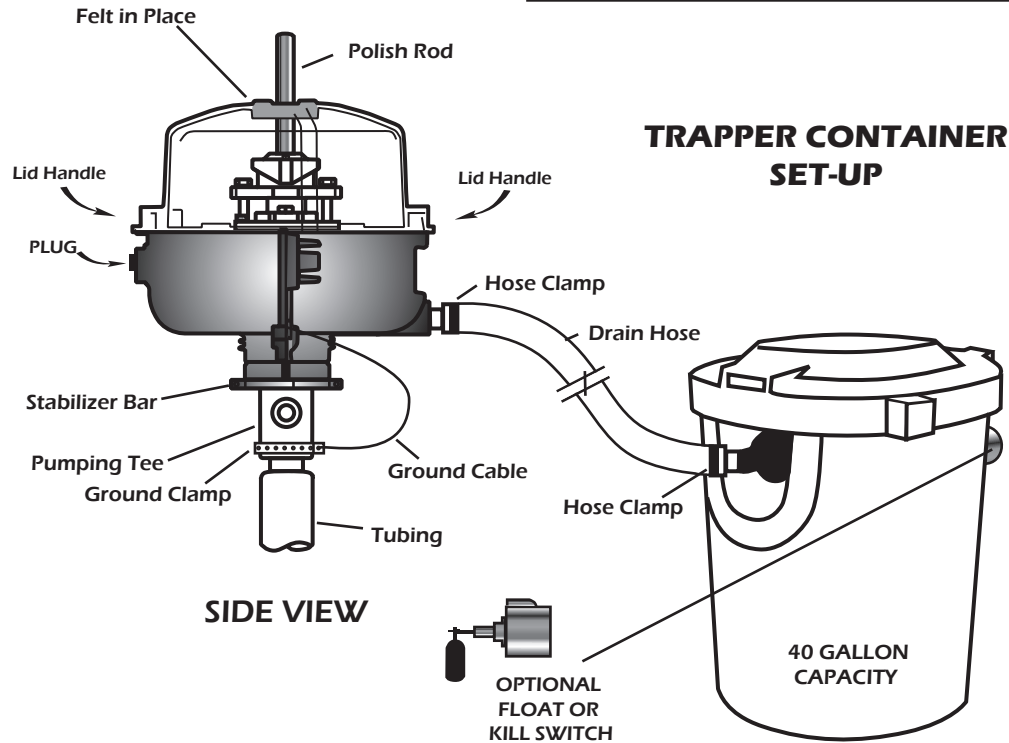

Attach 1 1/2" hose and hose clamps (available through supply store) to Trapper drain hole and Trapper container (using hose barbs provided). Set container in convenient place near stuffing box and strap to something near well or partially bury. If using optional float switch, the switch must be installed by a licensed / certified electrician in accordance with all local codes.

Attach float switch to side of Trapper. The float switch must be installed by a licensed / certified electrician in accordance with local codes. To the drain side: attach valve assembly.

*** Disclaimer- It is the responsibility of the operator to insure that float switch specifications are met & regular testing is performed.**